

- Application Boundary  
2.18 hectares / 5.39 acres
- Private Sewer
- Car Park : 237 Spaces  
Inc:  
10 Disabled Spaces  
5 Parent & Child Spaces  
32 Covered bicycle spaces
- EV Charger Bays (24no.)
- Plus Future Provision (24no.)

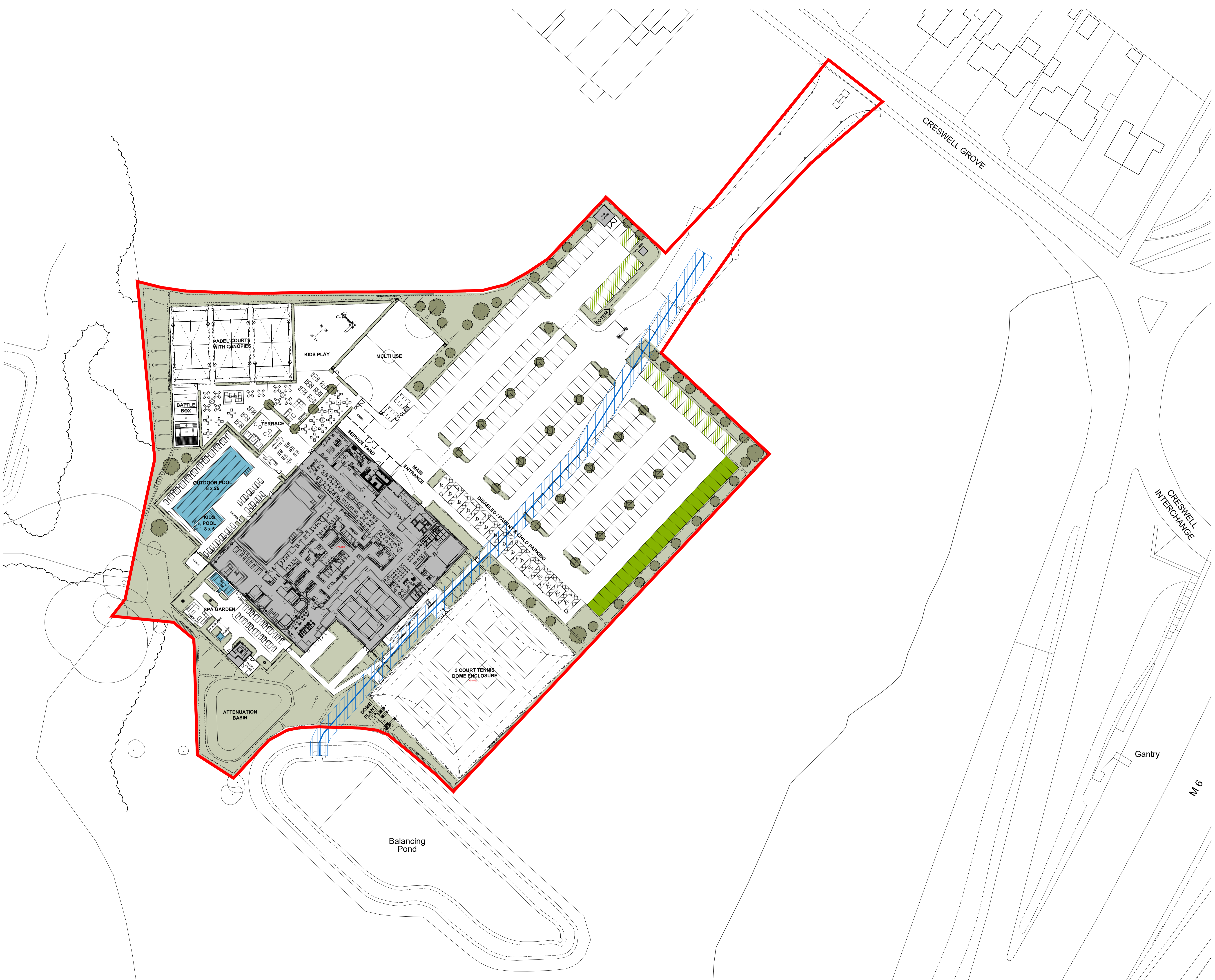

REVISION P03	BY: LG	CHECKED: MPB	DATE: 15/01/2026
Future EV spaces update.			
REVISION P02	BY: LG	CHECKED: MPB	DATE: 11/12/2025
Planning Issue.			
REVISION P01	BY: HP	CHECKED: MPB	DATE: 27/09/2024
Pre-App Issue.			

STATUS: **S4a | FOR PLANNING**



PROJECT: **STAFFORD GATE**

TITLE: **PROPOSED SITE PLAN**

**Hadfield Cawkwell Davidson**  
Broomgrove Lodge, 13 Broomgrove Rd, Sheffield, S10 2LZ T 0114 266 8181 www.hcd.co.uk

HCD PROJECT NO. <b>2023-115</b>	SCALE <b>1:500 @ A1</b>	REV <b>P03</b>
PROJECT NO. <b>23115</b>	ORIGINATOR <b>HCD</b>	VOLUME <b>ZZ</b>
LEVEL <b>00</b>	TYPE <b>DR</b>	ROLE NUMBER <b>A-PL-003</b>